



**ADDOWN REALTY**  
— Connecting You To Your Perfect Property —

# HOW ARE WE DESIGNING HAPPINESS FOR YOU?



What do you visualize when you think about a perfect home; A happy family? A healthy lifestyle? The convenience of every day? A beautiful house? A well-designed building?

We have drawn out a home for you taking into consideration all these factors. A home that is filled with comfort and luxury. A place where you and your family find happiness, with the amenities that are custom-made for each of you and the impeccable design and architecture.

# 3 BHK

# DESIGNED HOMES

Homes that are charged with positivity and creativity. Beautifully designed 3BHK flats, A home that you want to make countless memories in. Every little thing is carefully crafted and put in the perfect position to make your 3 BHK home a flawless abode for your lifetime.





## DESIGN THAT SELLS

The residential project with store outlets. It complements the project's immaculate exterior. Along with the architecture, the elevation is stunning. All of these things will ensure that the shops on the facade obtain exposure. It also makes it easier for the residents of Orchid to get anything they need. Hence, The design of orchid is the one that sells itself, to shopkeepers, to residents and also to a mere viewer.

# AMENITIES DESIGNED FOR YOU



When choosing a home for a lifetime, it's important to know about things besides the home, about amenities that come along with that home. Seventh Orchid offers you a multitude of diversified amenities. Amenities that are beneficial for your health, amenities that are good for your kids, amenities that will help you relax and a lot more. We have customised these amenities to suit all the members of your family and that is inclusive to all ages.



## DESIGNED FOR A LUXURIOUS LIFESTYLE

Living life with amenities that uplift the luxury of living.  
Adding splendour to the life of our residents.

-  Seating gazebo
-  Graphical plaza in garden
-  Lawn
-  Indoor play area



# DESIGNED FOR YOUR HEALTH

Health is a steaming topic in these times, hence Seventh Orchid makes it easy for its residents to keep track of their health.

-  Gymnasium
-  2 multi purpose play courts
-  Yoga space



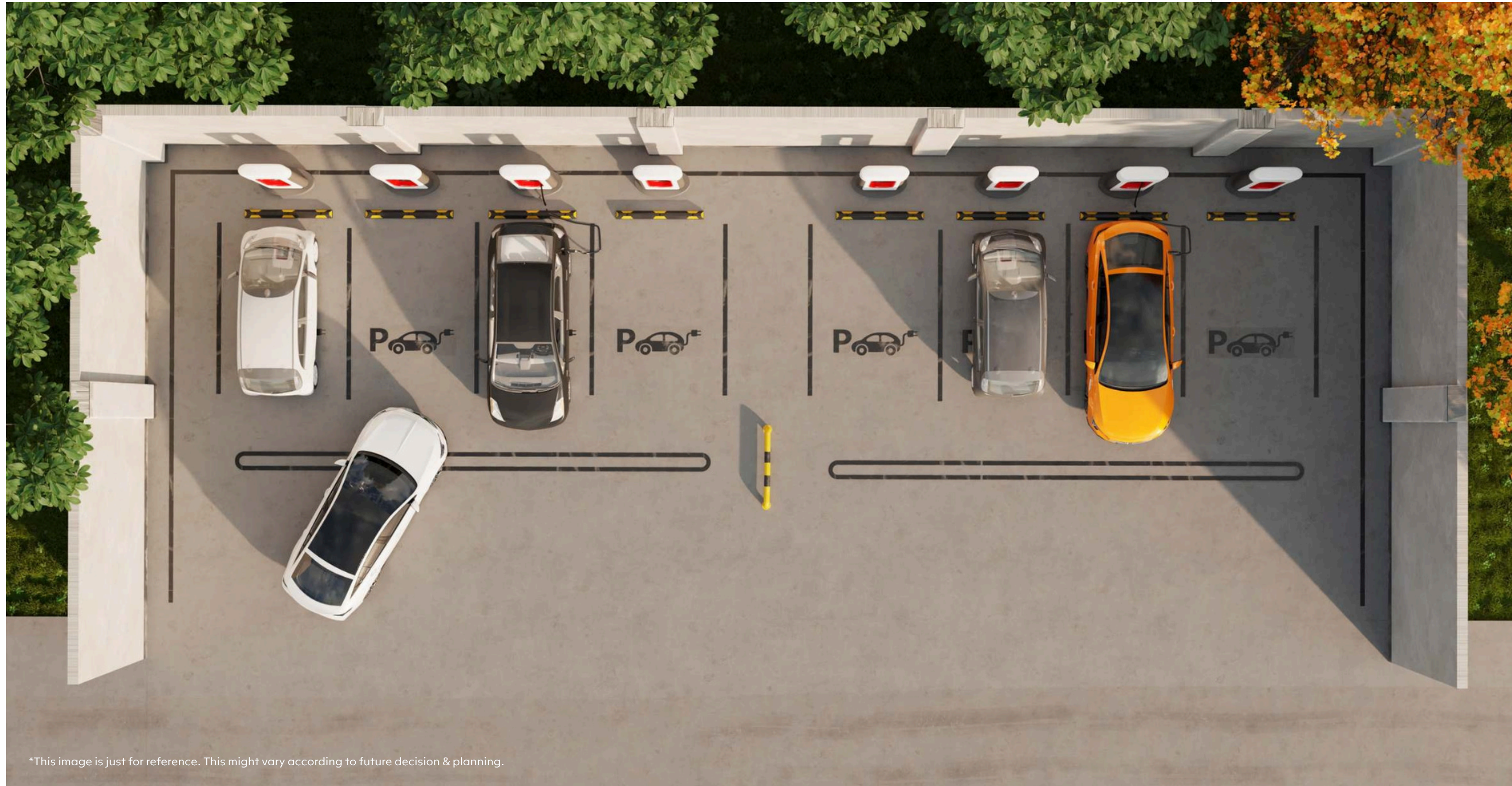



\*This image is just for reference. This might vary according to future decision & planning.

## DESIGNED FOR SMART LIVING

Keep up to date with the world. With high-tech amenities become the modern resident of this smart society.





-  Fast EV charging stations
-  Rainwater harvesting system

-  WiFi access



# DESIGNED FOR YOUR ENTERTAINMENT

When your home is an entertaining place, everyone in your family stays delighted. From kids to senior citizens.

-  Multi purpose hall
-  Home theatre
-  Toddlers play area
-  Kids play area

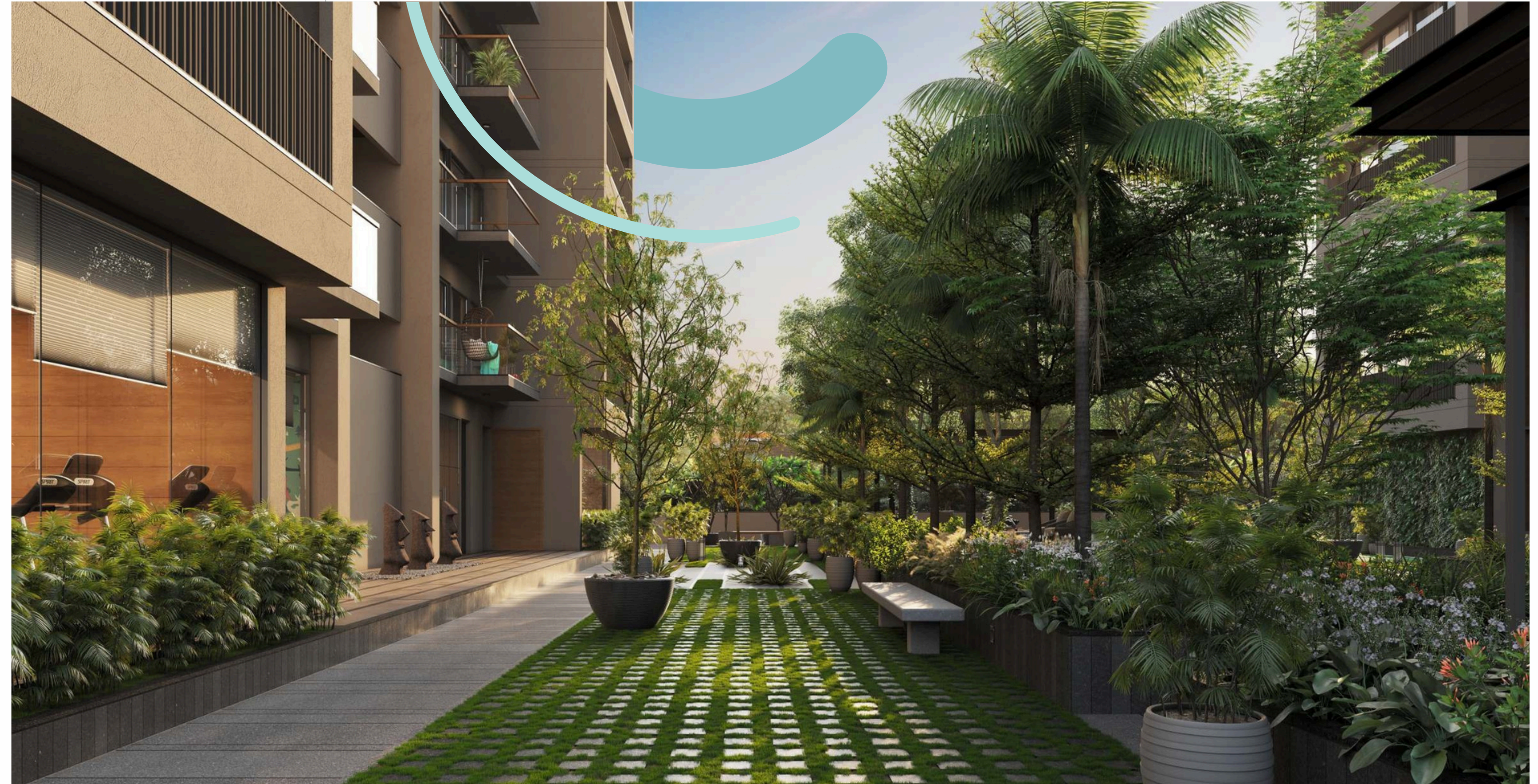



## OTHER AMENITIES

- 24 hrs water
- Drop off zone
- Power backup
- Reception & waiting area
- 24 x 7 securities
- CCTV camera
- Fire system
- Planter
- Car parking
- Society office
- Solar roof top

# EXCLUSIVELY DESIGNED SMART SOCIETY APP

A perfectly designed solution to make your living at Seventh Orchid a pleasant and convenient experience. It will be great aid to the residents, managing committee members and the security staff.



# DESIGNED FOR FOREVER JOY

Seventh Orchid is not only a project, but it is a promise of building lives that are bright and warm. Lives that are filled with comfort and luxury. Hence, we say that we are not only building homes we are designing a lifetime of Joy.

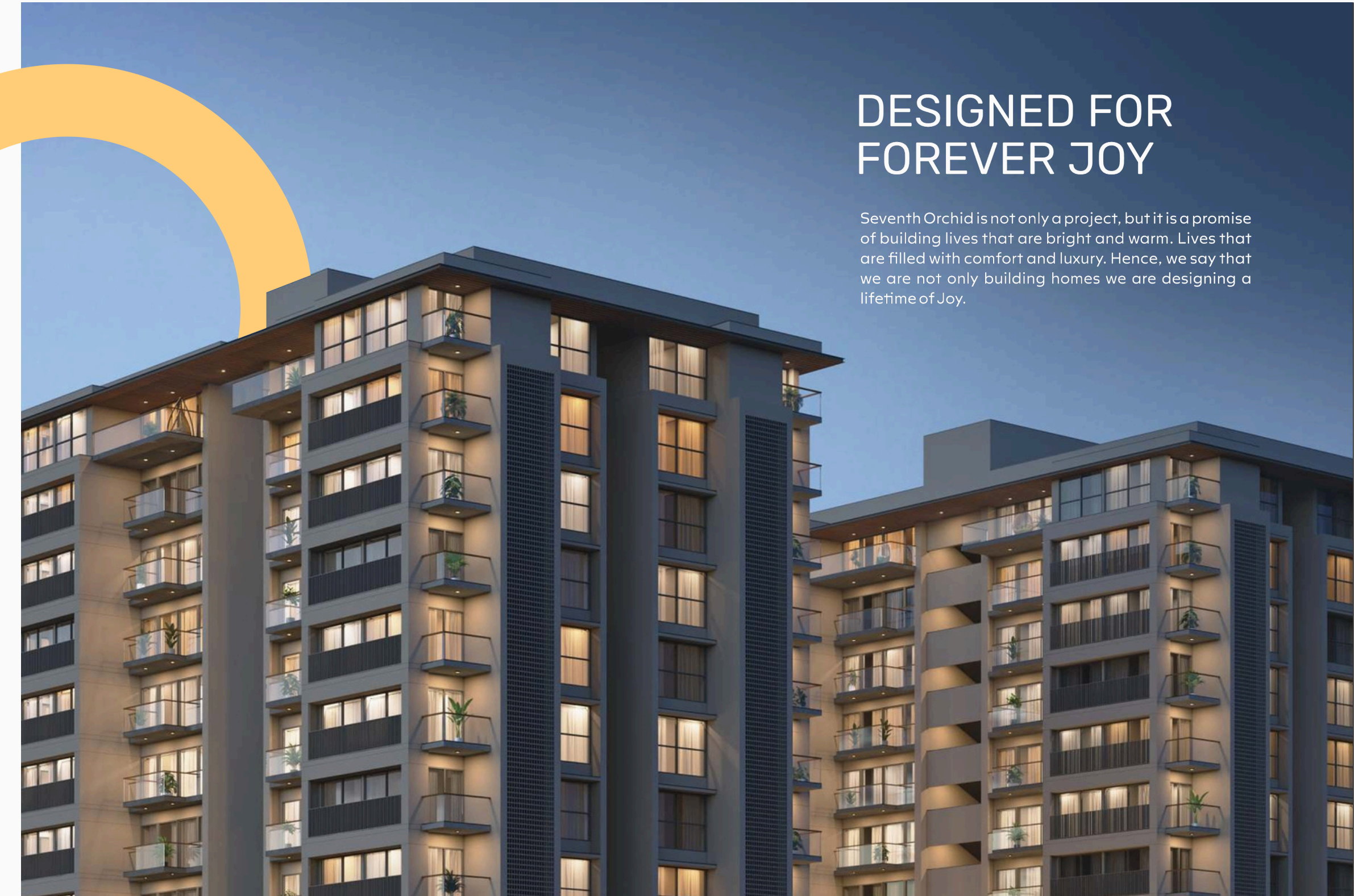

GROUND FLOOR



FIRST FLOOR



SECOND FLOOR



THIRD FLOOR



TYPICAL FLOOR (4th - 14th floors)

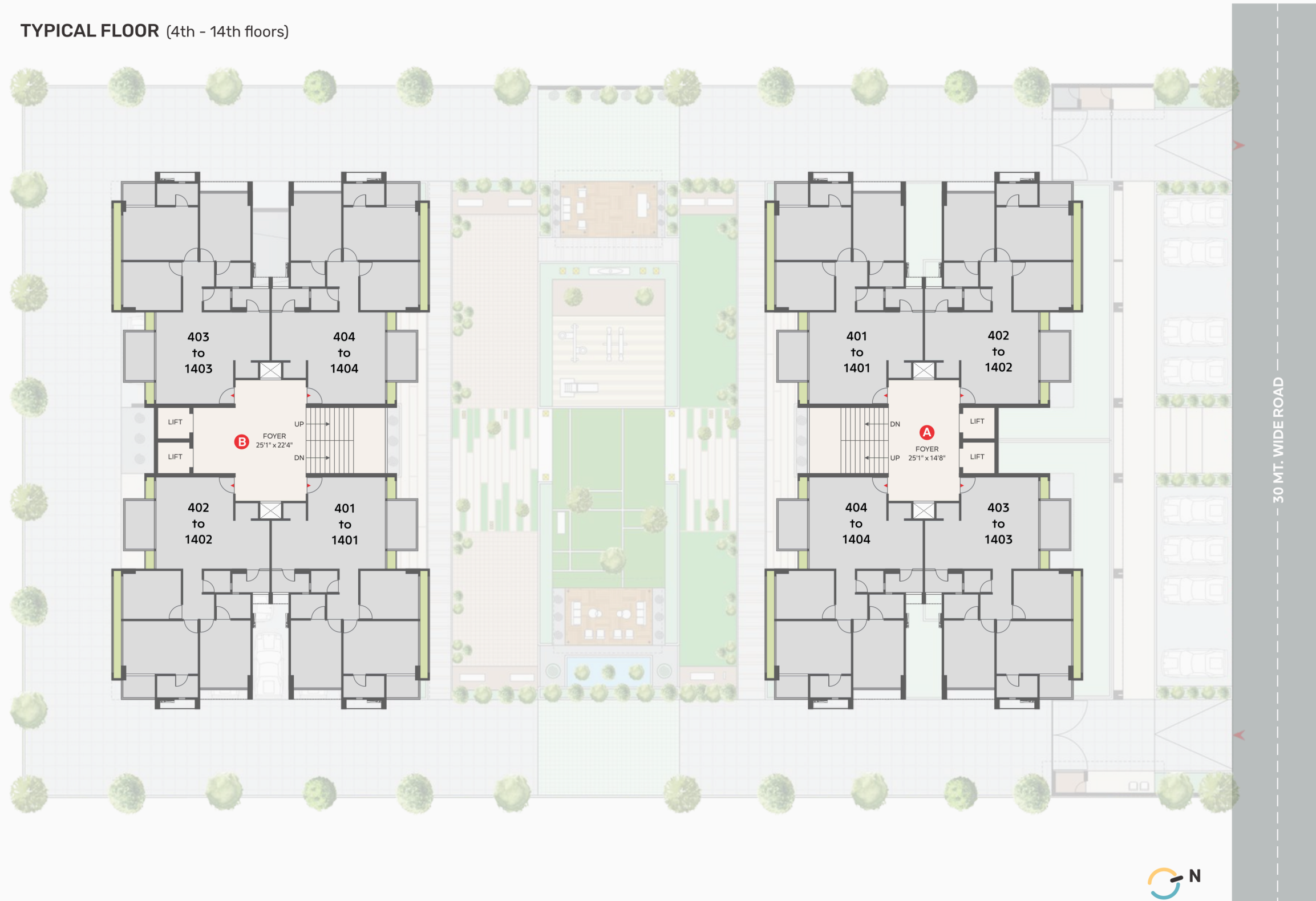

UNIT PLAN



BASEMENT - 1

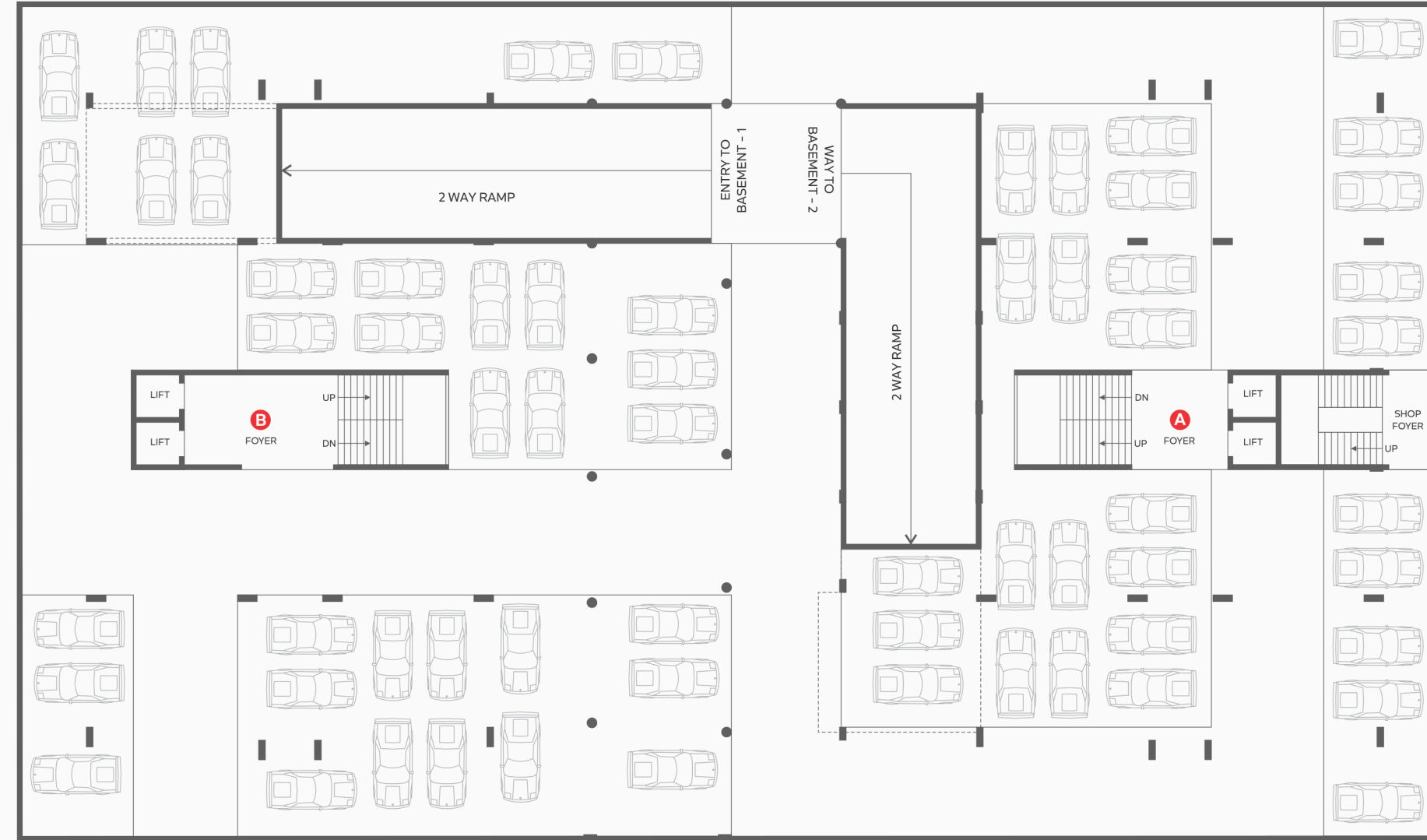

30 MT. WIDE ROAD



BASEMENT - 2



30 MT. WIDE ROAD



# SPECIFICATIONS

A house is created with small things and even though these things might appear small they are not insignificant. Thus, it is of utter necessity to keep in check that only the best quality of products is used because building a house that brings joy should be up to the standard and should be safe so that it can last for a lifetime.

## STRUCTURE

- Earthquake resistant structure.

## WALL FINISH

- Inside wall plaster with putti finish.
- Double coat plaster with texture paint on external walls.

## DOOR AND WINDOWS

- **Main door:** Designer flush door with natural veneer, with wooden frame.
- **Other door:** Flush door with wooden frame.
- **Windows:** Premium quality aluminum windows.

## FLOORING

- Vitrified flooring in living, dining, kitchen and all bedrooms.

## KITCHEN

- Mirror polished granite platform with premium quality stain proof SS sink.
- Decorative tile dado lintel level.

## BATHROOM AND PLUMBING

- Separate wet and dry area.
- Vitrified tiles till lintel level.
- CPVC - UPVC pipes and branded accessories with company warranty.
- Branded ceramic fittings.
- Electric geyser point and exhaust fan provision in all bathrooms.

## WASH AREA

- Vitrified tiles floor in wash area.
- Dado glaze tiles.
- Electric & plumbing points for washing machine & water purifier.

## ELECTRIFICATION

- Three phases conceal copper wiring with ISI wires & branded modular switches.
- ELCB / MCB with internal distribution board.
- Provision for TV cable & telephone points.

## INTERCOM SYSTEM & VDP

- Intercom system and Video Door Phone (VDP) in all units.

## TERRACE

- Tile / China mosaic in terrace area with water proofing.

