

9.00 in



ADDOWN REALTY

— Connecting You To Your Perfect Property —

13.00 in

# THE NOBLE REGAL LIVING

The 3 and 4 BHK homes and shops are the homes that let one rediscover the epitome of prestigious life. The project is situated behind Nirma University, close to the S.G. highway offering excellent connectivity.





# STEPPING TOWARDS ELITE



ELEVATED  
LIFESTYLE.

Discover an elevation that reflects the character and sensibilities of the residents and excellent accessibility results in an elaborate residence that stands out.



# LANDSCAPED VIEWS



FRESHNESS  
ALL AROUND.

Spectacular as the accompanied homes, the residents can lift their spirits in the comfortable luxurious oasis of landscaped gardens and amenities.



# THE REFINED LAVISH SCENES

## ENTRANCES OF LAVISH



IT ALL STARTS  
FROM ENTRANCE.

Be greeted with an exclusive artistic architectural wonder upon entering. The property entrance has a contemporary water fountain installed that reflects the luxury of the overall structure.



## MAJESTIC WIDE VIEWS



ONLY YOU  
AND THE VIEW.

The overarching facade gives spectacular unobstructed views from the balconies and slider windows. Open surroundings ensure an unrestricted flow of air and light.





# COMFORT MEETS ELEGANCE

## A BOUNDLESS REALM



SIT. TALK OR  
HAVE FUN.

Several in-built additions deliver a luxurious experience. The contemporary amenities offer a host of excitement, entertainment and easement.



ELEVATED  
LEISURE LIVING  
IT UP



## TERRACE FLOOR AMENITIES

Yoga deck

Gazebo

Swing area

Barbeque area

Sit out

Open air theatre

Pocket garden



- Home Theater
- Library and Work From Home Space
- Gym
- Indoor games
- Skating area
- Garden
- Children play area
- Multi purpose court
- Senior citizen sit out
- Common sit out
- Multi purpose hall

## GROUND FLOOR AMENITIES

# GROUND FLOOR



# TYPICAL FLOOR



# TERRACE FLOOR

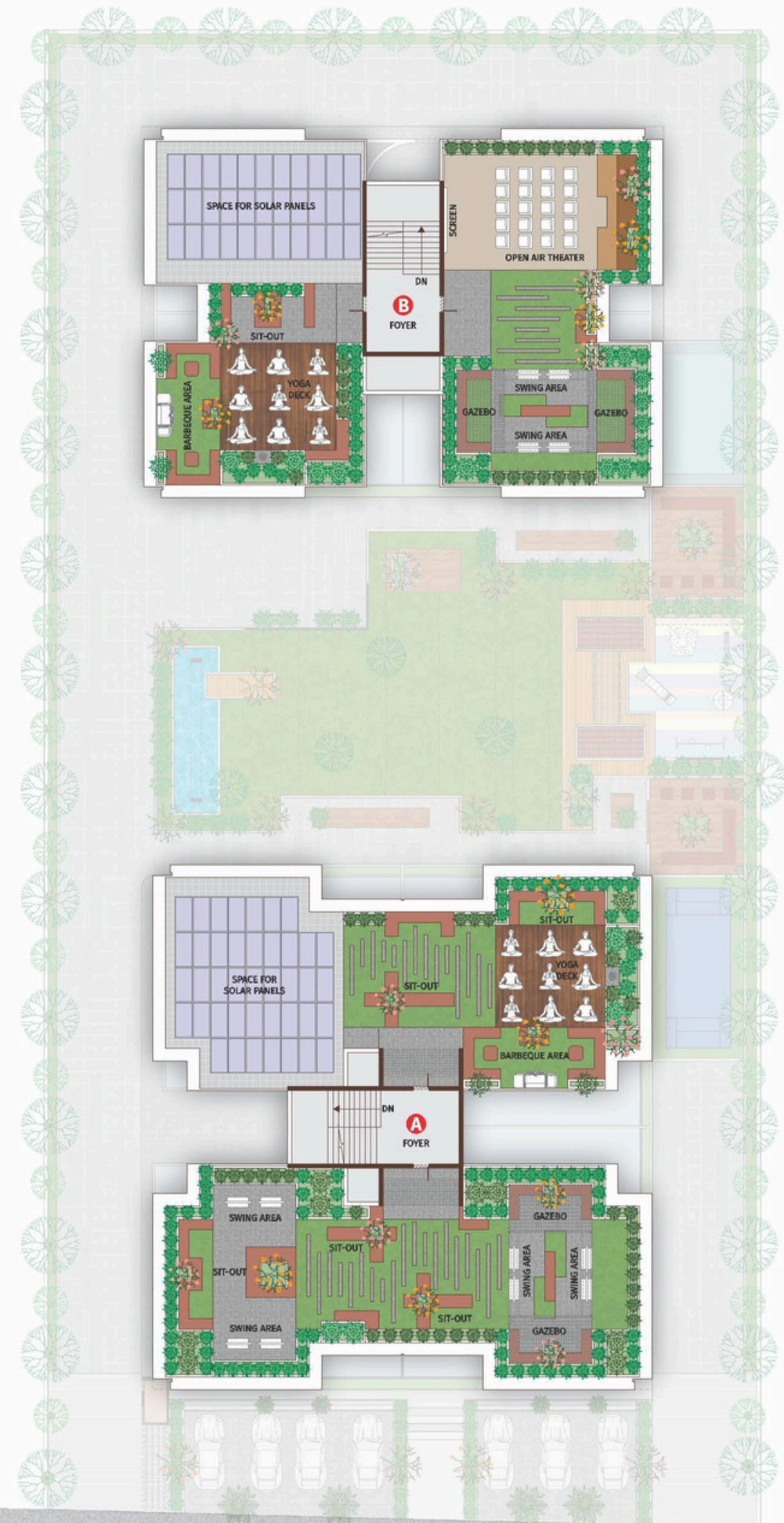

### 3 BHK



### 4 BHK





PANORAMAS  
OF LANDMARK  
LUXURY