



ADDOWN REALTY

— Connecting You To Your Perfect Property —



## A HOME THAT COMPLETES THE CIRCLE OF YOUR HAPPINESS

An amalgamation of space and aesthetics which brings completeness to your perspective of a home. A perfect home for those who look for an advanced living experience. These 3 and 2 BHK homes are sure to please you with its unique style of architecture and design with the amenities that will take your lifestyle a step ahead.











15 MTR ROAD

GROUND FLOOR PLAN



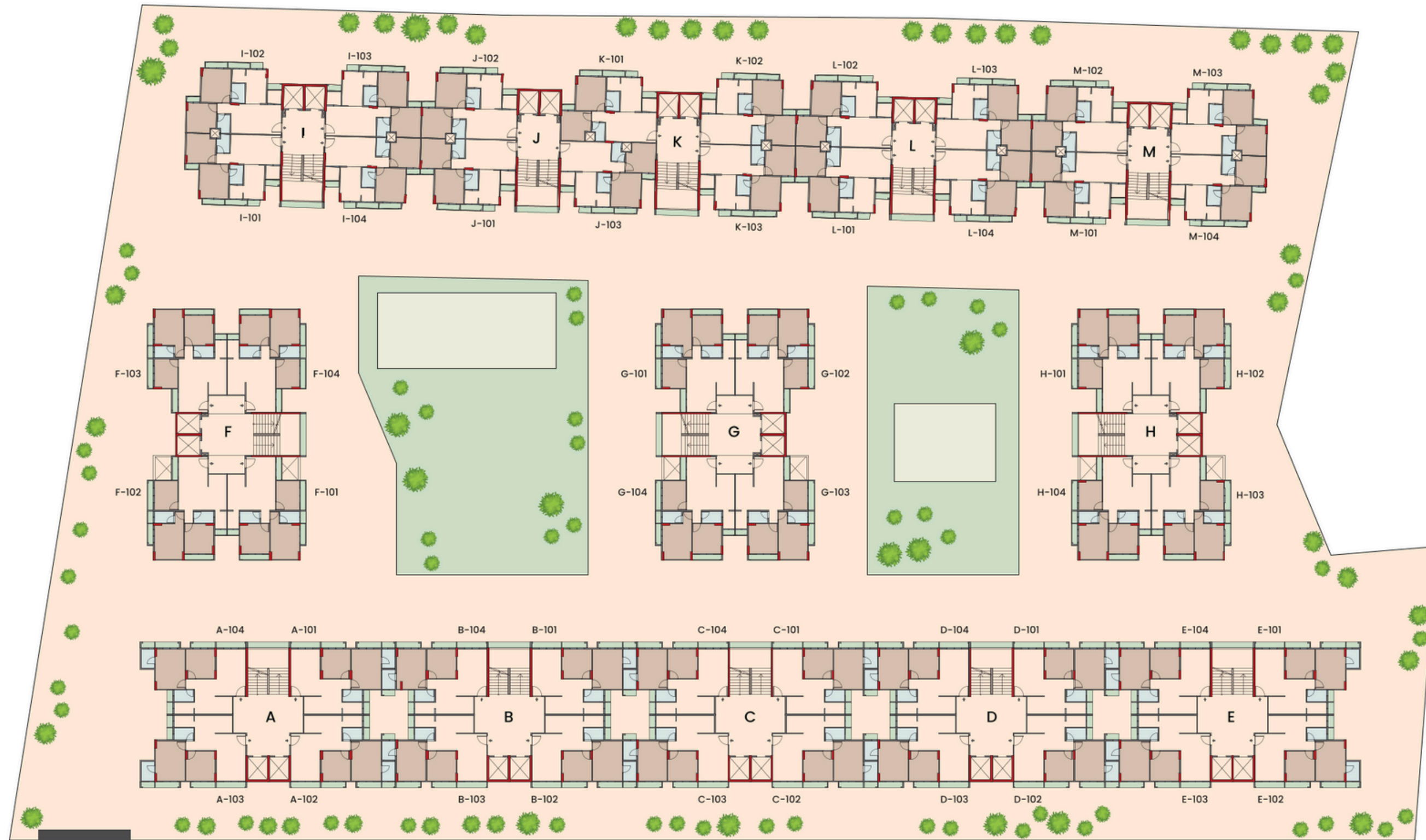

15 MTR ROAD

TYPICAL FLOOR PLAN





## 2 BHK - TYPE 1

Tower A, B, C, D, E

Rera Carpet - 596 Sq. Ft.

Wash Area - 26 Sq. Ft.

Built-Up Area - 654 Sq. Ft.

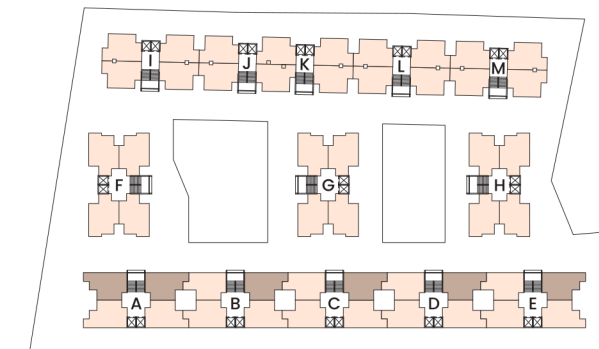



## 2 BHK - TYPE 2

Tower I, J, K, L, M

Rera Carpet - 553 Sq. Ft.  
 Wash Area - 20 Sq. Ft.  
 Balcony Area - 22 Sq. Ft.  
 Built-Up Area - 622 Sq. Ft.

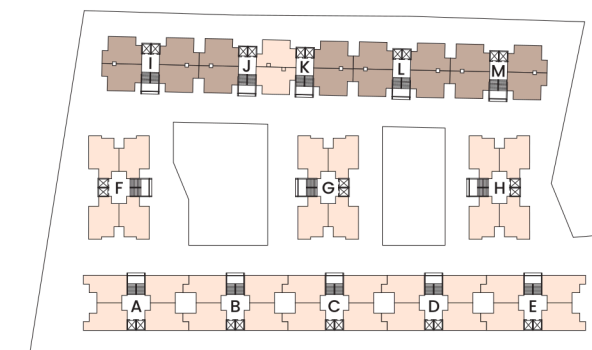



**3 BHK**  
Tower F, G, H

Rera Carpet - 646 Sq. Ft.  
Wash Area - 24 Sq. Ft.  
Built-Up Area - 703 Sq. Ft.

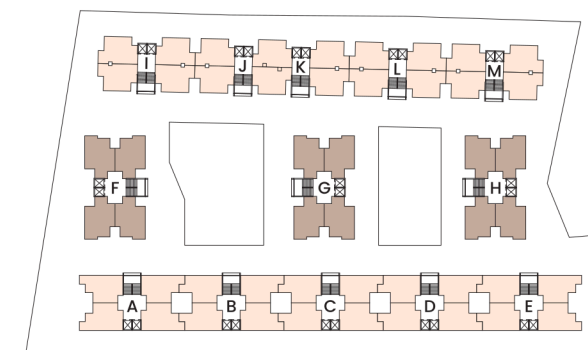

↑  
Pre-Vestibule  
5'11" X 6'4"







## SPECIFICATIONS

- Good quality elevators (2 elevators per block)
- Well designed entrance foyer
- Common area under CCTV surveillance
- Fire hydrant system in every block
- Provision for DTH connection
- All internal roads of RCC/pattern designed stone paving
- Trimix flooring for ground floor drive way and basement
- Well planted complex with landscaped garden
- 2 Level of basement parking

## AMENITIES

- Drop off zone
- Lawn
- Kids Play Area
- Indoor Games
- Garden Sit-outs
- Multi-Purpose Court
- Gym
- Box Cricket
- Yoga Deck
- Zen Garden
- Jogging Track