



ADDOWN REALTY

— Connecting You To Your Perfect Property —

A LIFE SURROUNDED BY

Grace



WE DON'T JUST ELEVATE LIFESTYLES WE UPLIFT SOULS. WITH A SACRED JAIN TEMPLE AND A SERENE MAHADEV TEMPLE NESTLED WITHIN, YOUR EVERYDAY BEGINS WITH BLESSINGS AND ENDS IN BALANCE.

JAIN TEMPLE

A SANCTUM OF STILLNESS, WHERE SILENCE SPEAKS AND EVERY STONE ECHOES CENTURIES OF DEVOTION.

MAHADEV TEMPLE

WHERE THE COSMIC RHYTHM OF LORD SHIVA PULSES THROUGH CALM WINDS, INVITING YOU TO PAUSE, REFLECT, AND RISE WITHIN.





AN EXPRESSION
OF BEAUTY AND *Aesthetic*



8700 SQ YARD
RESIDENTIAL PLOT

■ **PODIUM LIVING**

■ **PURE RESIDENTIAL**

■ **216 FT WIDE FRONTAGE**

- 
- ▣ BASEMENT
 - ✦ GROUND FLOOR
 - + 1ST FLOOR PARKING SPACE
 - + 2ND FLOOR PODIUM AMENITIES
 - + 3RD TO 23RD REDEFINE LIVING SPACE
 - + TERRACE - HORIZON SPACE

A FACADE THAT CARVES
YOUR SIGNATURE INTO THE

Skyline

BASEMENT



- **SECURE & FUNCTIONAL BASEMENT PARKING**
- EFFICIENT VEHICULAR MOVEMENT AND SAFETY DESIGN
- FIRE SAFETY PROVISIONS AND MECHANICAL VENTILATION



GROUND FLOOR



- TOWER ENTRANCE LOBBIES
- DROP-OFF ZONES
- RECEPTION AREAS
- LANDSCAPE ZONES & SEATING ALCOVES



FIRST FLOOR



- 2 VEHICLE AND CAR PARKING SPACES
- STORE ROOM
- COMMON UTILITY TOILET





SECOND FLOOR (PODIUM)



- GYM WITH LOCKER & WASHROOM
- AMPHITHEATRE
- CAFÉ WITH OPEN KITCHEN
- 3 GUEST ROOMS WITH ATTACHED WASHROOMS
- BANQUET HALL WITH STAGE
- DINING HALL WITH KITCHEN & STORE
- TODDLER ROOM
- YOGA DECK
- LIFE-SIZE BOARD GAMES





- 2 UNITS PER FLOOR
- CROSS-VENTILATED PLANNING
- ALL SIDES OPEN APARTMENTS
- SPACIOUS LIFT LOBBY WITH WAITING AREA

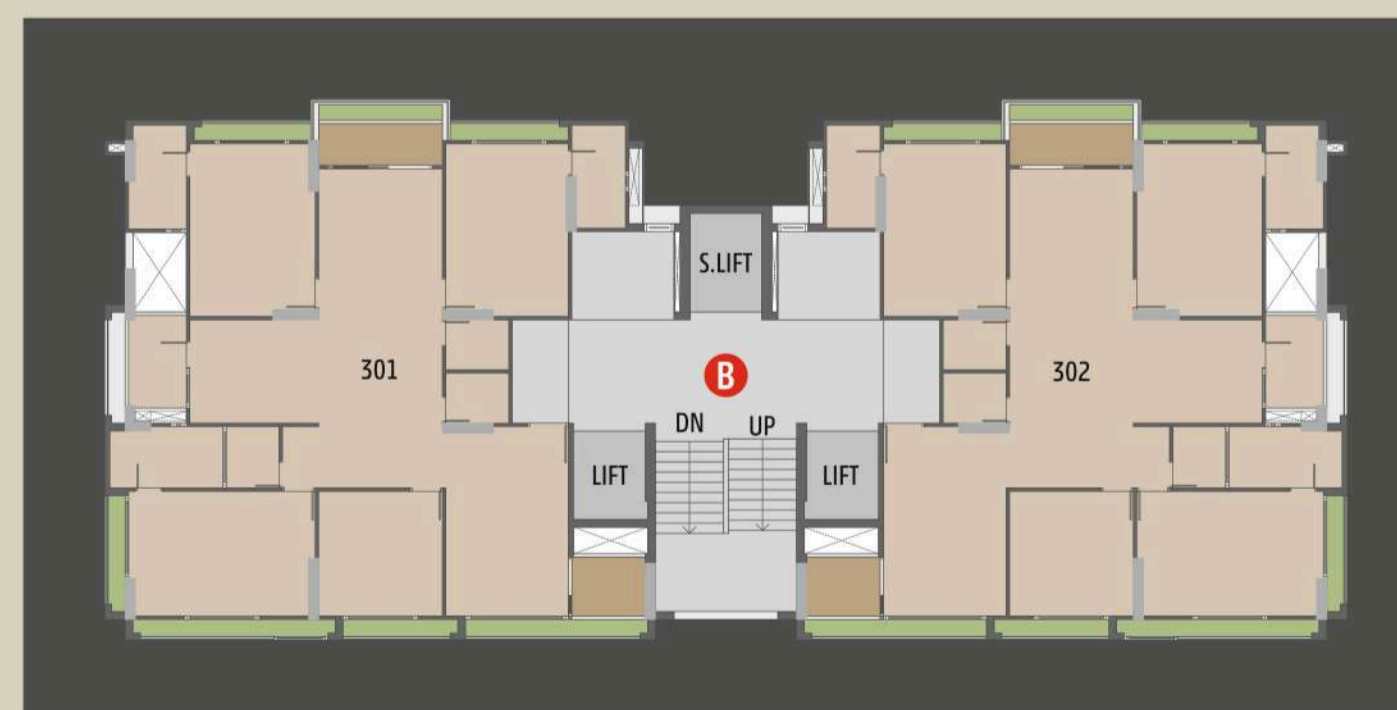
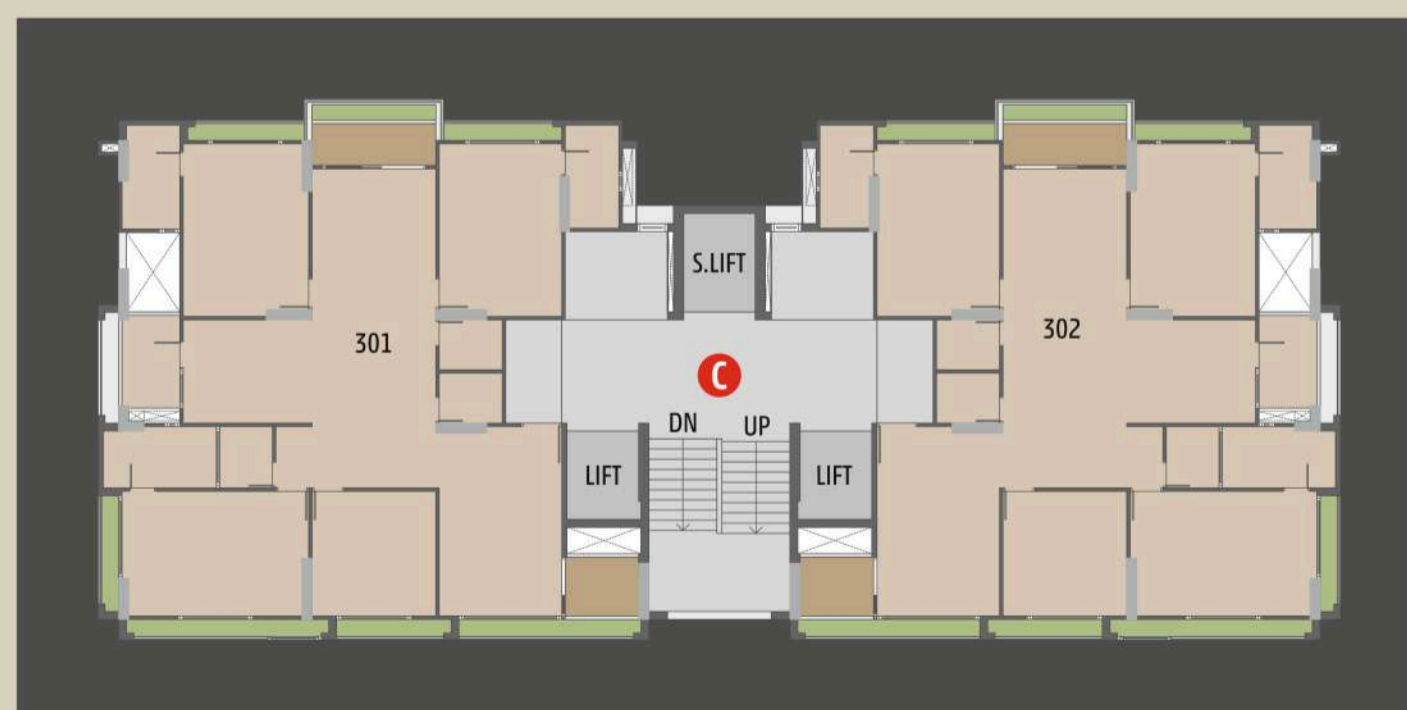
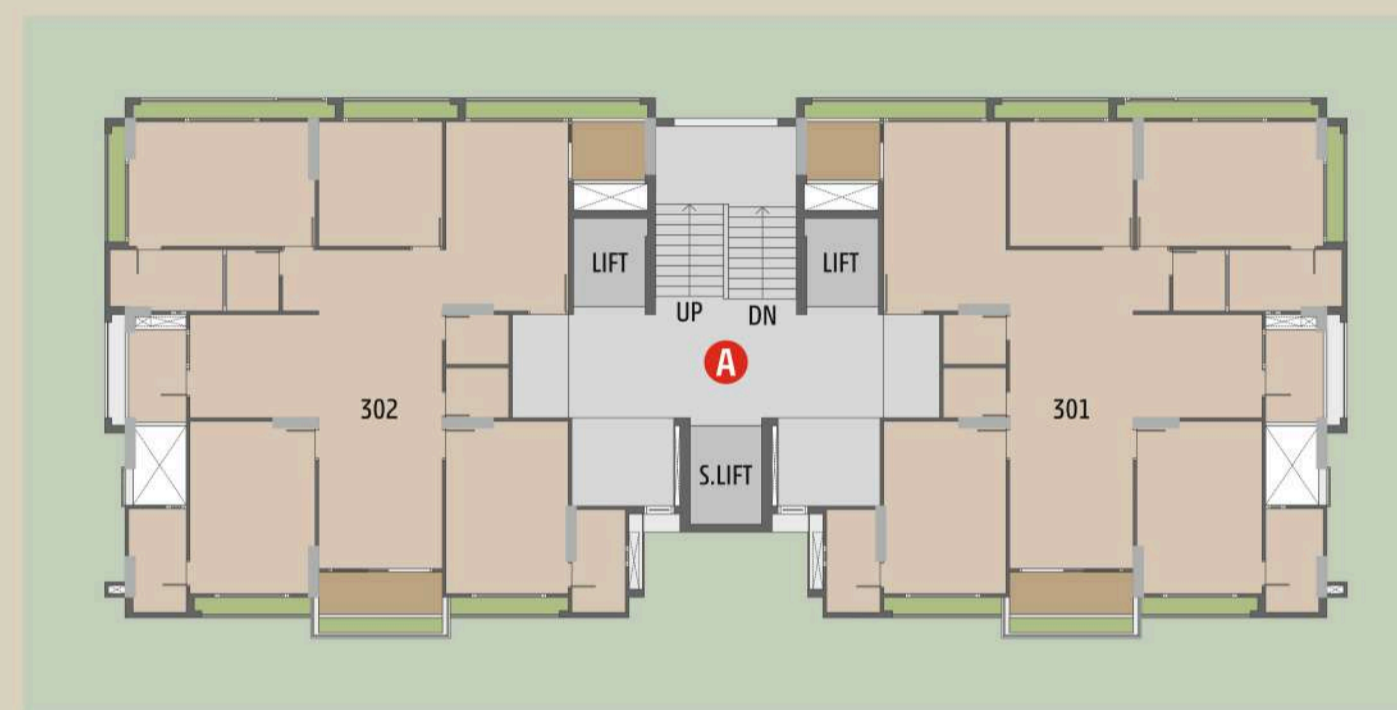
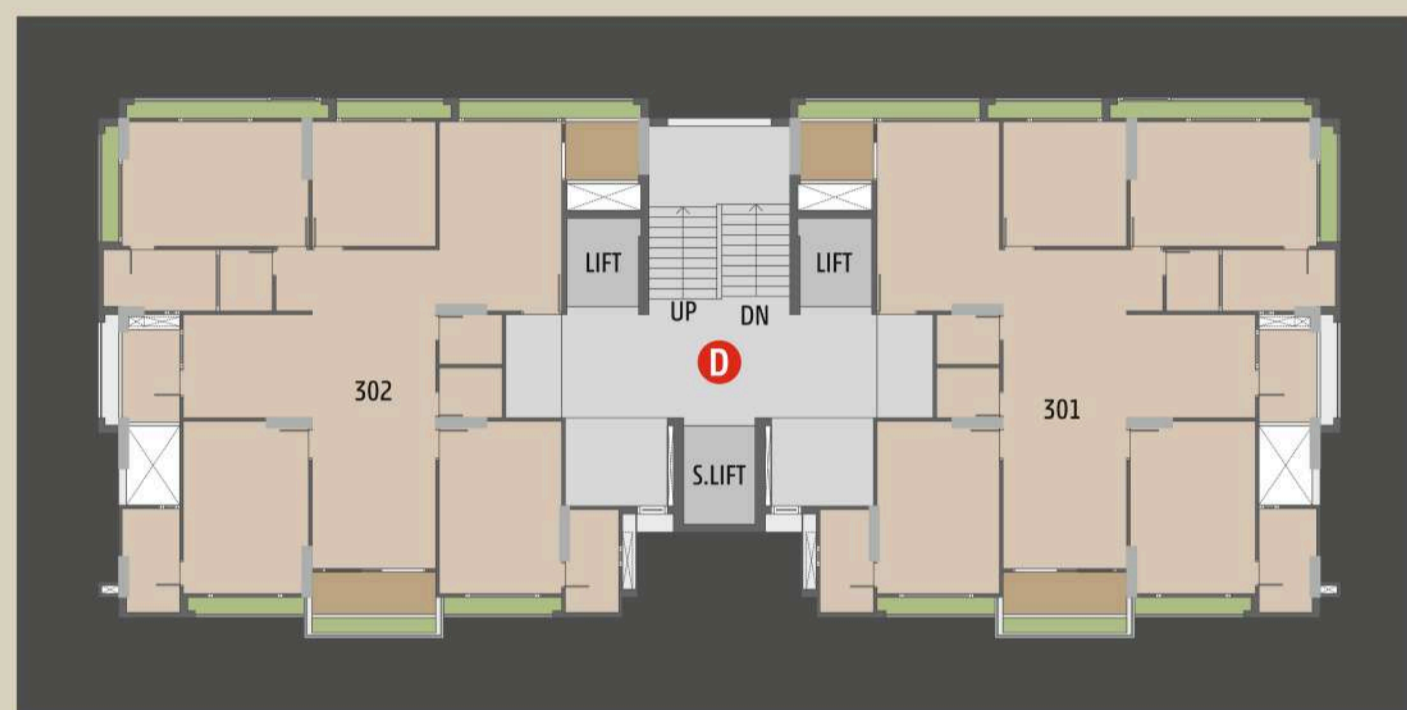

UNIT PLAN - A 301

- MULTIPURPOSE OFFICE SPACE
- GRAND FOYER SPACE AT HOME ENTRANCE
- 2 LIVING AREAS WITH SUNRISE & SUNSET VIEW BALCONIES
- VASTU-COMPLIANT POOJA ROOM
- MASTER BEDROOMS WITH CLOSETS
- FULL-HEIGHT WINDOWS IN ALL MASTER BEDROOMS
- VRV SYSTEM PROVISION

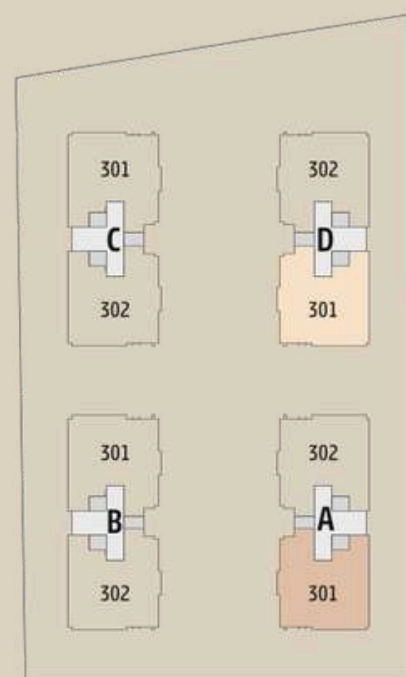

UNIT PLAN - A 302

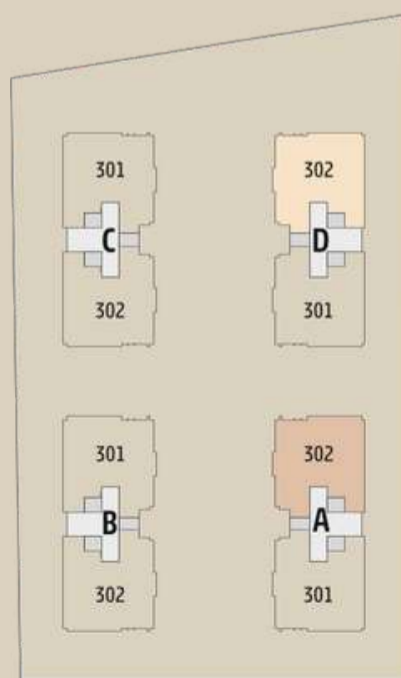



UNIT UNIT - B 301

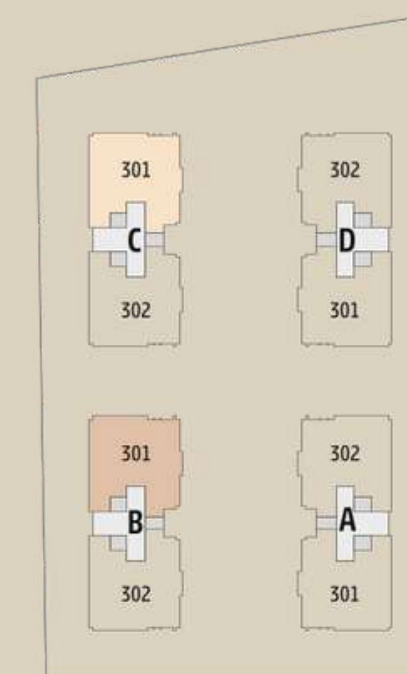



UNIT PLAN - B 302

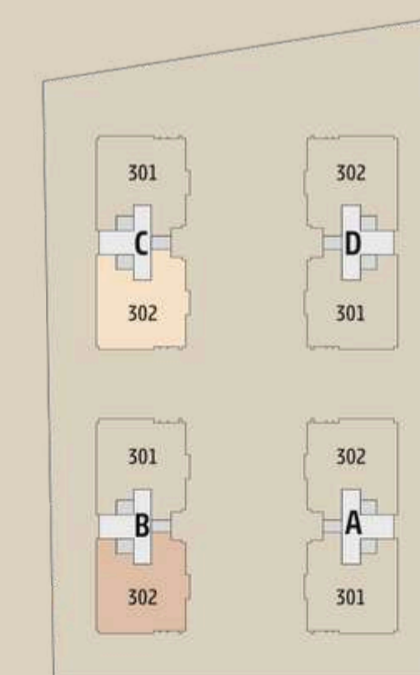

TERRACE FLOOR



- SOLAR PANEL PROVISION
- COMMON PARTY LAWN
- SKY SEATING AREA
- SERVICE ZONES DEMARCATED FOR EFFICIENCY

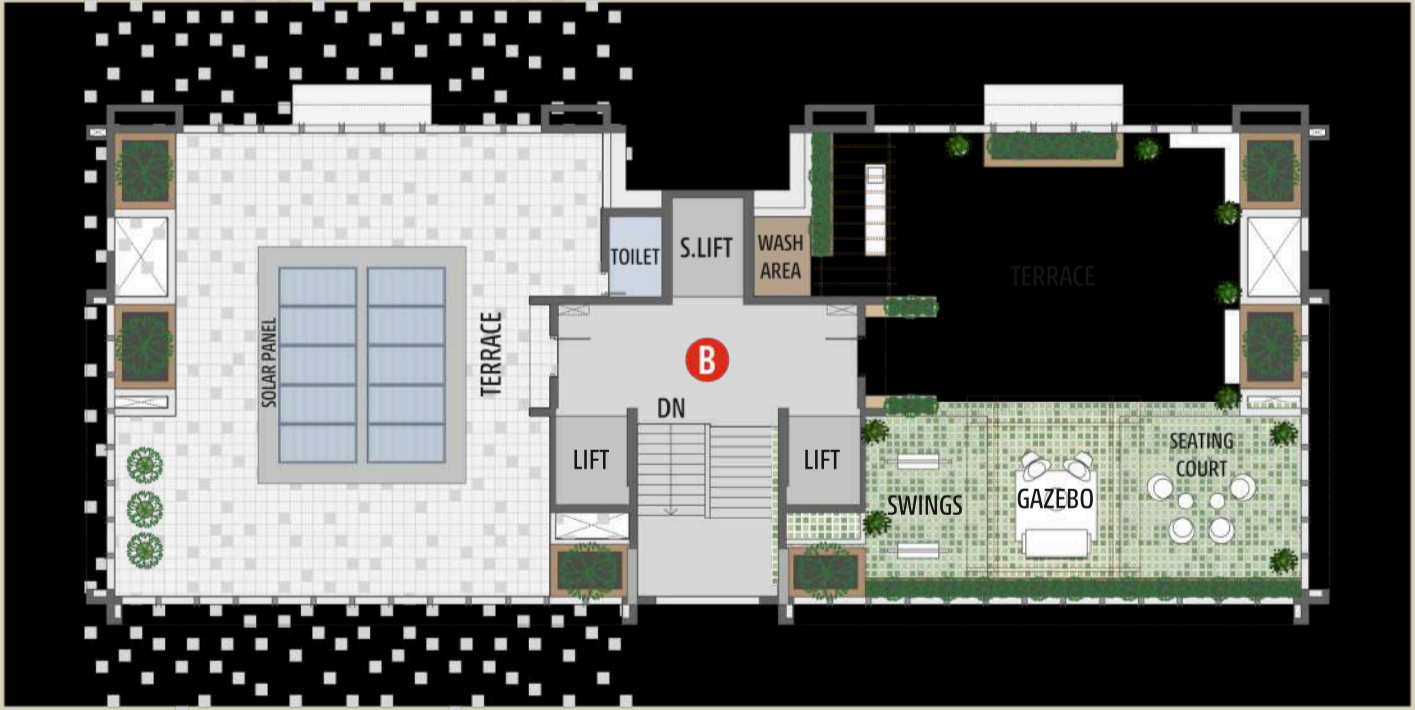
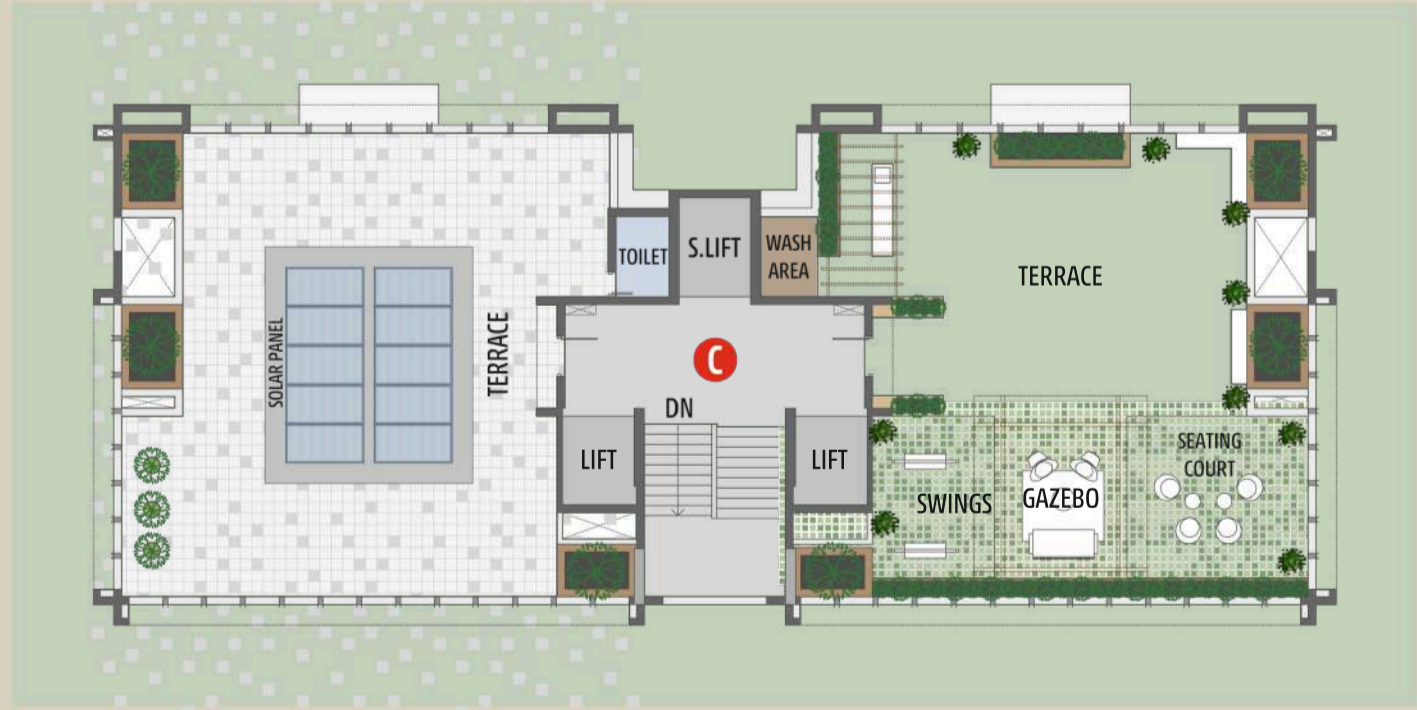
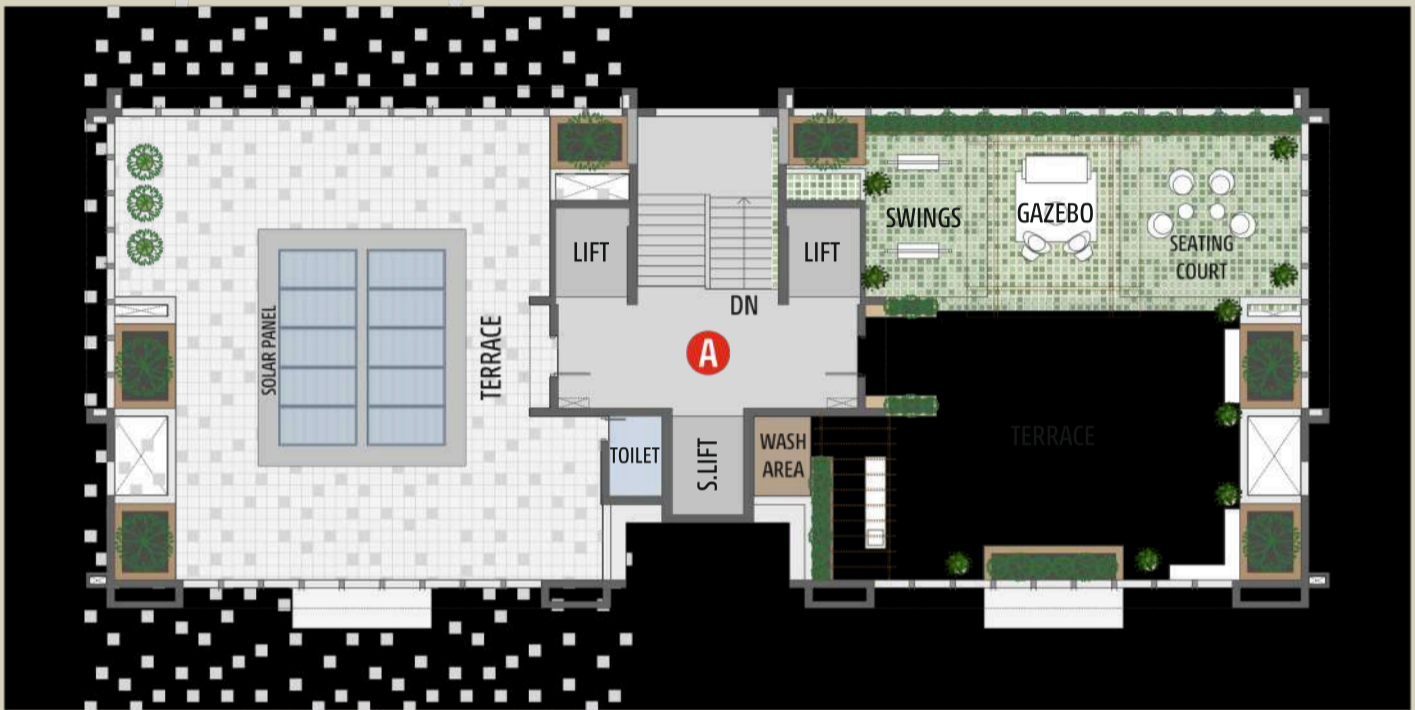
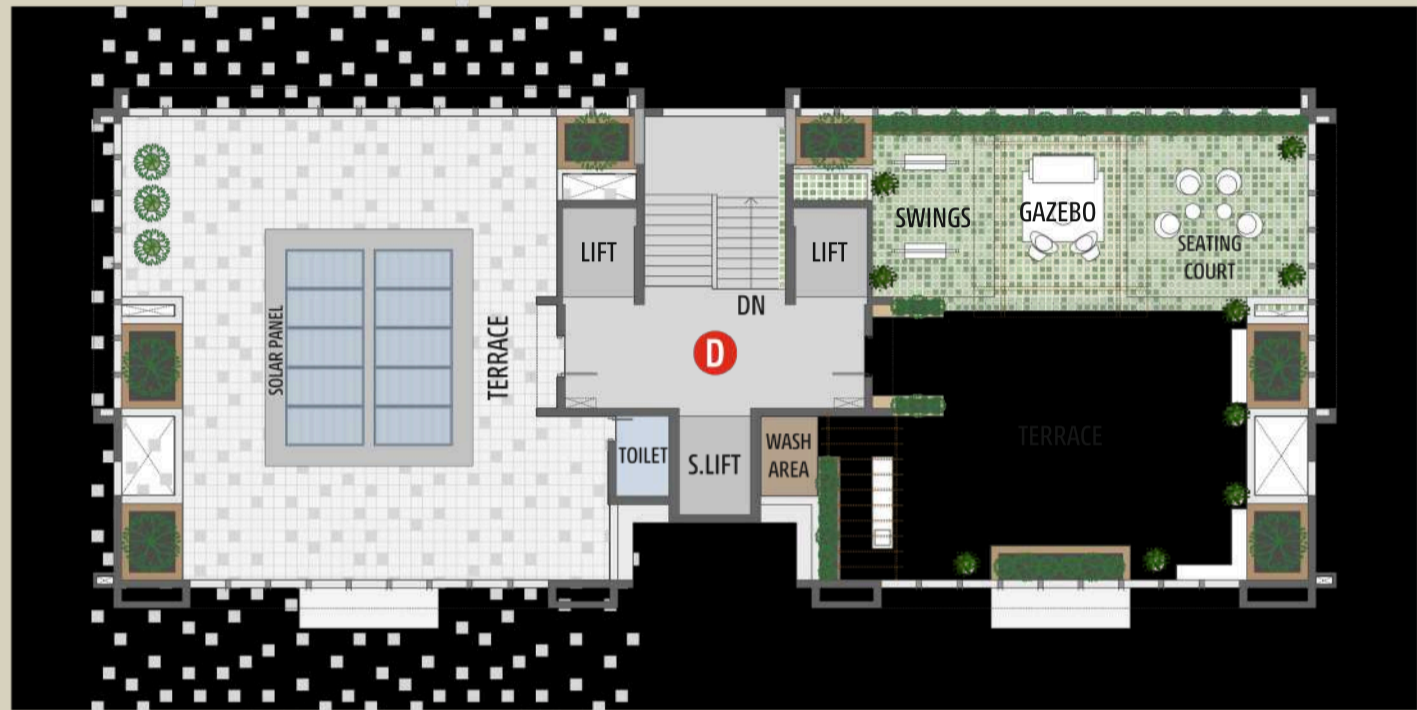

AMENITIES THAT
BRING NEIGHBORS

Together



- BANQUET HALL
- 3 FULLY FURNISHED GUEST BEDROOMS WITH WASHROOM
- GYMNASIUM WITH LOCKER ROOM
- TODDLER ROOM
- CAFETERIA WITH KITCHEN
- INDOOR GAMES AREA
- MINI THEATRE
- SKATING RINK

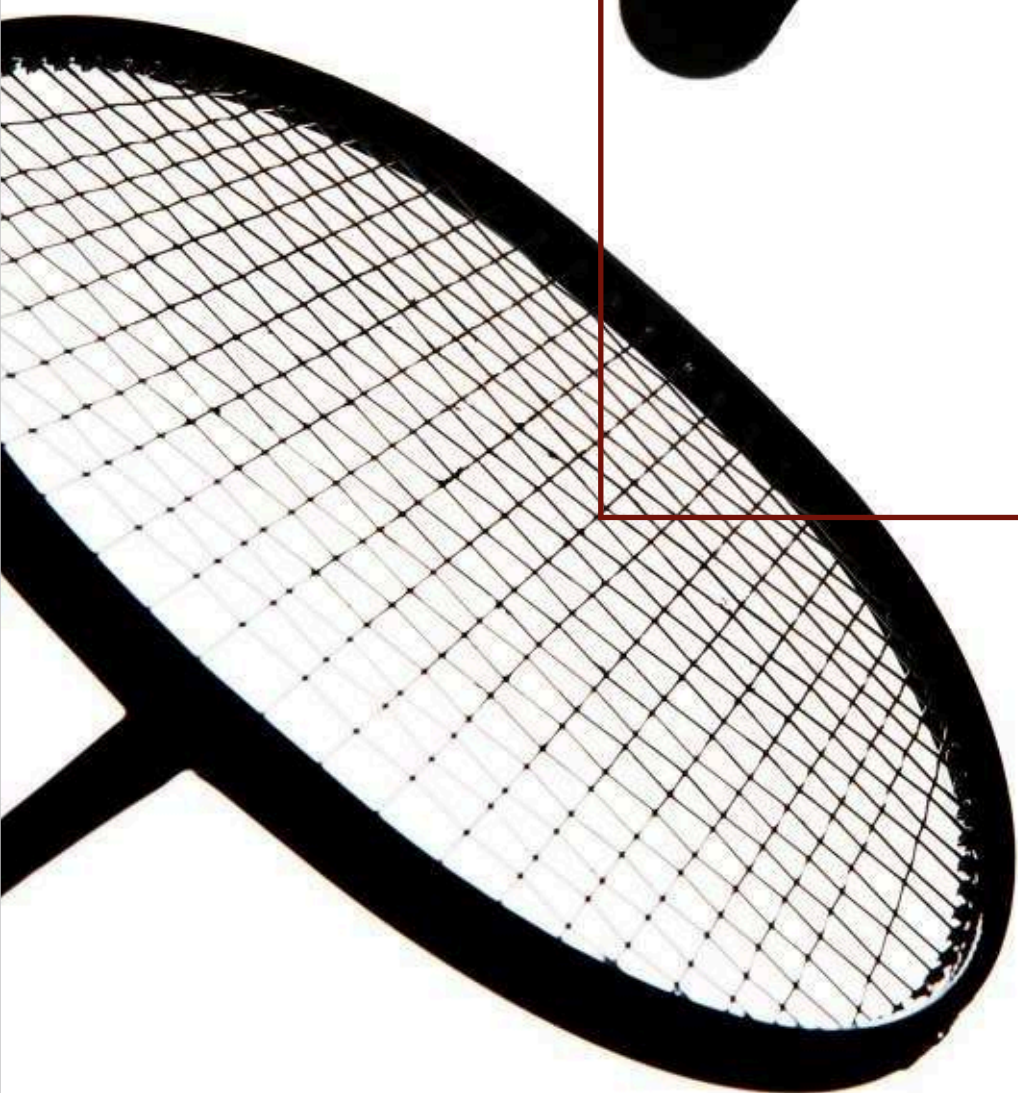

- MINI BASKETBALL COURT
- MULTIPURPOSE HALL WITH KITCHEN
- AMPHITHEATRE WITH WATER BODY
- CHILDREN'S PLAY AREA
- YOGA DECK
- BADMINTON COURT
- GARDEN WITH SITTING AREA
- JOGGING TRACK



- BOARD GAME PLAZA
- OPEN DECK WITH SCREEN WALL
- SALON AND SPA - MASSAGE AREA
- GARDEN WITH SITTING AREA
- SENIOR CITIZEN SIT OUT
- CONFERENCE ROOM
- CHAIRMAN'S CABIN
- AESTHETIC ENTRANCE WITH WATER BODY
- CHILDREN DROP OFF ZONE
- DOUBLE-HEIGHT FEATURE WALL



- SWING ON EACH TERRACE
- PERGOLA SEATING WITH PLATFORM
- VIEWING DECK
- SOLAR PANELS
- SECURITY CABIN
- WAITING LOUNGE AREA IN EACH BLOCK
- CAR WASH AREA



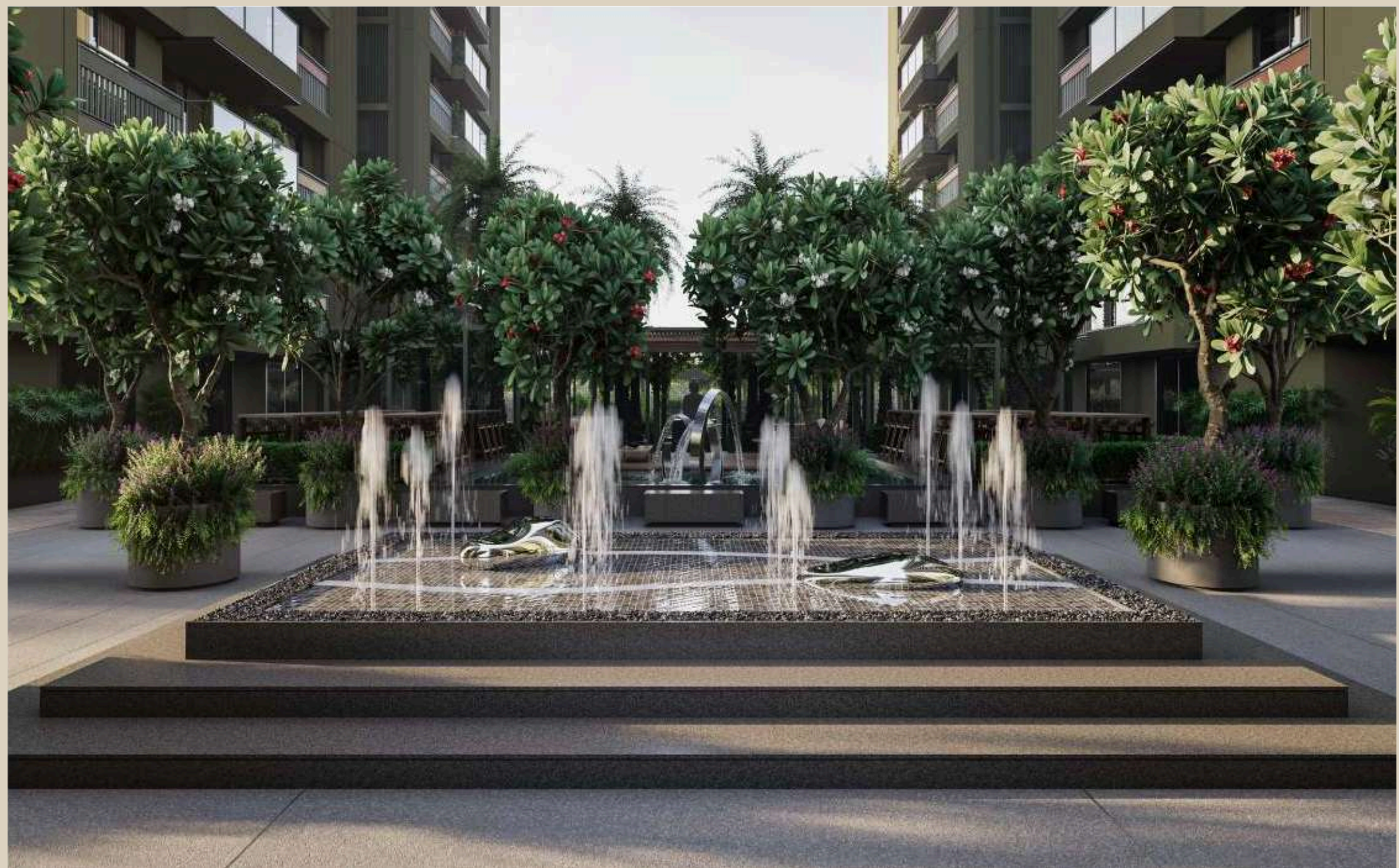





BRAND WE USE

STEEL

- STEEFO TMT, VINAYAK TMT

FLOORING

- SIMPOLO CERAMICS, QUTONE

SANITARYWARE

- HANSGROHE, KOHLER

LIFT

- MITSUBISHI ELEVATORS

CEMENT

- ULTRATECH CEMENT

PLUMBING

- ASTRAL PIPES, HULIOT

BATH FITTING

- HANSGROHE, KOHLER

SWITCHES

- ABB, LEGRAND

CABLE

- APAR CABLES, FINOLEX

PAINT

- NEROLAC, ASIAN PAINTS



SPECIFICATIONS

FLOORING

- PREMIUM QUALITY VITRIFIED TILES.
- NATURAL GRANITE/ RUSTIC TILES IN BALCONY.
- GRANITE AND ANTI-SKID TILES FLOORING AND VITRIFIED TILES UP TO LINTEL LEVEL IN BATHROOM AS PER ARCHITECT'S DETAILS.
- MAIN FLOORING TILES: 4X6.
- BATHROOM FLOORING TILES: 2X4.

KITCHEN

- PREMIUM QUALITY VITRIFIED TILES AND PLATFORM AS PER ARCHITECT'S DETAILS WITH S.S. SINK AND TILES UPTO LINTEL LEVEL.
- CRUSHER POINT, R.O. SYSTEM POINT AND PLUMBING POINT.

DOORS & WINDOWS

- PREMIUM QUALITY FLUSH DOOR WITH BOTH SIDE VENEER WITH CLEAR COAT AND WOODEN FRAME.
- SLIDING/OPENABLE ANODIZED ALUMINIUM WINDOWS AS PER ARCHITECT DETAILS.

PLUMBING

- CONCEALED PLUMBING OF PREMIUM QUALITY CPVC PIPES. C.P. FITTINGS & SANITARY WARE OF REPUTED BRANDS.
- TOP OF THE LINE CP FITTINGS AND SANITARY WARES.
- SEPARATE HOT AND COLD-WATER LINES FOR ALL BATHROOM.

ELECTRIFICATION

- 3 PHASE CONCEALED ISI COPPER WIRING WITH PREMIUM MODULAR SWITCHES, MCB AND ELCB DISTRIBUTION PANEL.

WASH AREA

- ANTI-SKID FLOORING AND DEDO OF VITRIFIED TILES UP TO SILL LEVEL.
- PROVISION OF ELECTRIC AND PLUMBING POINT FOR WASHING MACHINE AND DISH WASHER.

PAINT AND WALL FINISH

- EXTERNAL DOUBLE COAT SAND FACE PLASTER AND TEXTURE WITH FULLY ACRYLIC PAINT.
- INTERNAL SINGLE COAT MALA PLASTER WITH DOUBLE COAT PUTTY FINISH.
- CEILINGS WITH EXPOSE RCC WITH RENDERING.

ELEVATOR

- PREMIUM QUALITY AUTOMATIC ELEVATORS.

WATER

- 24-HOUR WATER SUPPLY FROM OVERHEAD WATER TANK BY PRESSURE PUMP.